

Suporte platibanda

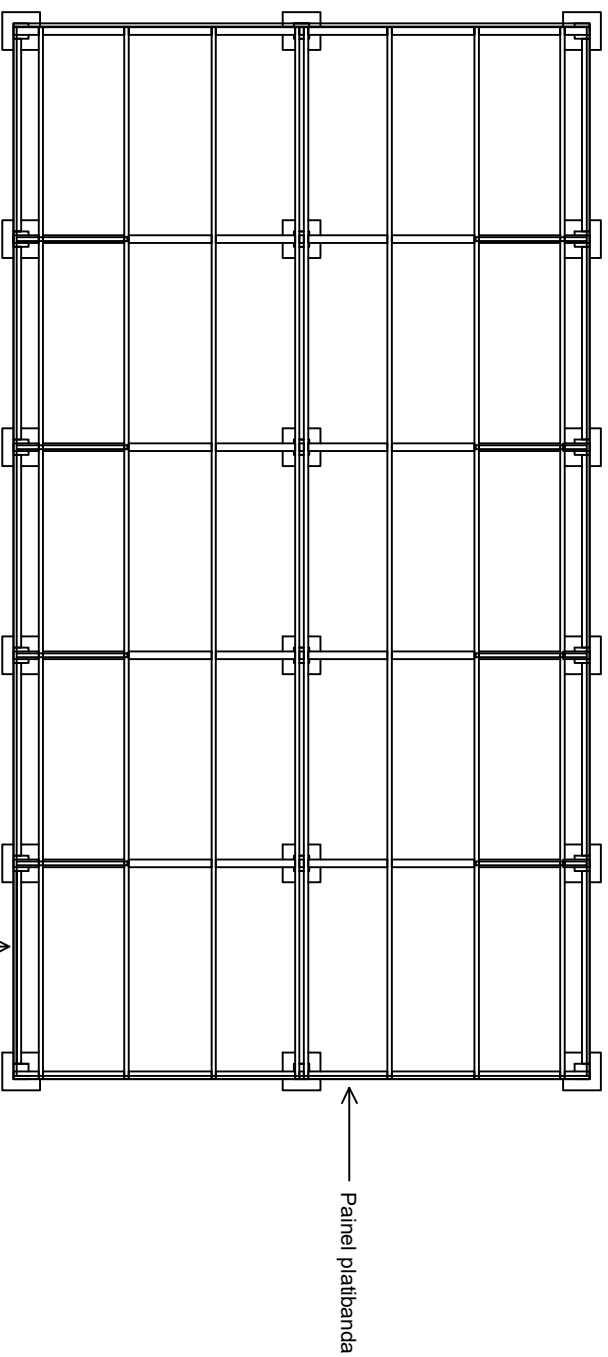

Superior

Painel platibanda

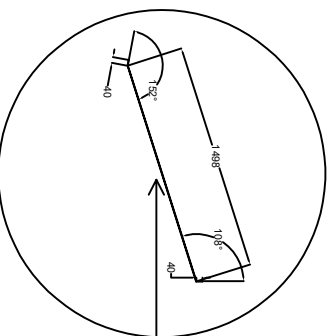

Suporte em barra
chata 2"x2,5mm com
as extremidades
dobradas

Detailne

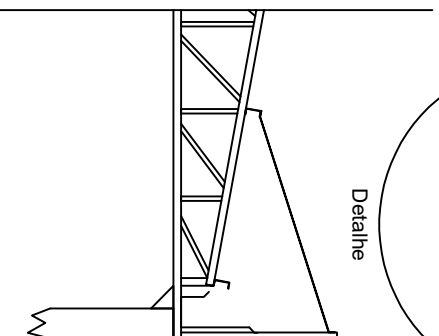

Frontal

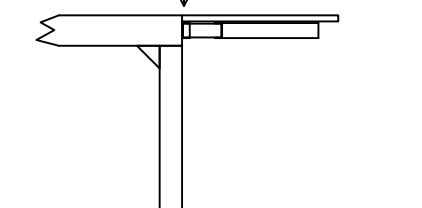

Lateral

ES

EXTREMO SUL ARQUITETURA LTDA.

RUA PADRE ANCHIETA Nº1330 - PELOTAS - CEP 96015420

PROJETO ESTRUTURAL

DESIGN OF EN

DEBENHO E NO. RICARDO Y. MARTIN DA ROSA SILVEIRA

NOME DA PESSOA

SUPORTE PLATIBANDA

PROFESSOR

PROFESSURA MUNICIPAL DE PEDAGOGIA - CNP/67466631000167

PAUL P. CHEN, AVEL T. FICHNARCO

ENG. RICHARD TAVARES DA MOTA SILVEIRA - CREA/RS 280109

10/12